

MX Nozzle Technology

mastip[™]
hot runner solutions



Low moulding temperature and pressure, excellent temperature consistency and front loading capabilities, the Mastip MX nozzle is specifically designed for multi cavity manifold systems and hot halves.

The MX nozzle is suited for small to medium applications in all types of markets. It is able to process a wide range of plastics, from the easy ethylenes to tough engineering resins.

Mould Design

- Efficiently designed profile to allow closer cavity pitching
- Shares the same gate profiles as BX and SX
- Available in both thermal and valve gate options
- Consistent nozzle lengths across the range
- Ability to mould large parts with smaller nozzles due to optimum flow characteristics

Operation

- Wide moulding window
- Excellent temperature profile and thermal stability
- Operates at low moulding pressure and temperature
- Optimum cycle times due to superior thermal insulation
- Uses an advanced micro coil heater embedded into a copper alloy sleeve

Installation and Maintenance

- Front loading capability for easier servicing of tips, heaters and thermocouples
- Simple machining and installation requirements
- Improved reliability due to the use of advanced materials
- Common tip and nut options provide ready availability of spare parts

MX Nozzle Technology

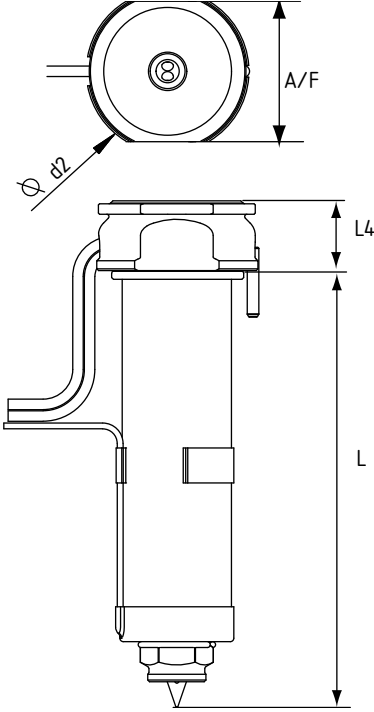

Availability

	13 Series	16 Series	19 Series
L	45		—
	55		
	65		
	75		
	95		
	115		
	130		
	145		
A/F	24	26	36
d2	28	30	40
L4	12		15

All measurements are in millimetres.
Available in H13 and 420 steel.

Gating Options

